



Cullen Performance Hall  
UNIVERSITY OF HOUSTON

# Technical Package



CULLEN PERFORMANCE HALL  
At University of Houston  
4300 University Dr,  
Houston, TX 77204



<b>Contact</b>	<b>3</b>
<b>Social Media</b>	<b>4</b>
<b>Directions</b>	<b>5</b>
<b>Tour Truck Route &amp; Parking</b>	<b>6</b>
<b>Guest Parking</b>	<b>9</b>
<b>Seating Map</b>	<b>10</b>
<b>Venue Floor Plan</b>	<b>12</b>
<b>Stage Information</b>	<b>13</b>
<b>Line Set Information</b>	<b>14</b>
<b>Stage Power Information</b>	<b>15</b>
<b>Dressing Room Layout</b>	<b>16</b>
<b>Green Room</b>	<b>19</b>
<b>Lighting System</b>	<b>20</b>
<b>Sound System</b>	<b>21</b>
<b>Video System</b>	<b>23</b>
<b>Loading Dock</b>	<b>24</b>
<b>Furniture</b>	<b>25</b>
<b>Bar/Lounge/Lobby/ Balcony/ 4<sup>th</sup> floor</b>	<b>27</b>
<b>General Information</b>	<b>30</b>



Theater Director

**Brandon Ferkel**

Office: 832-842-3131

Email: [btferkel@Central.UH.EDU](mailto:btferkel@Central.UH.EDU)

Front of House Manager

**Erin Shelly**

Office: 832-842-3131

Email: [emshelly@Central.UH.EDU](mailto:emshelly@Central.UH.EDU)

Box Office

Office: 832-842-3131

Email: [cphguest@central.uh.edu](mailto:cphguest@central.uh.edu)

Fresh Fork Catering

Office: 713-743-2202

Email: [catering@uh.edu](mailto:catering@uh.edu)



@CPH\_Houston



@CULLENPERFORMANCEHALL



@CPH\_Houston



@CPH\_Houston





**Address: 4300 University Drive, Houston Texas 77204-0001**

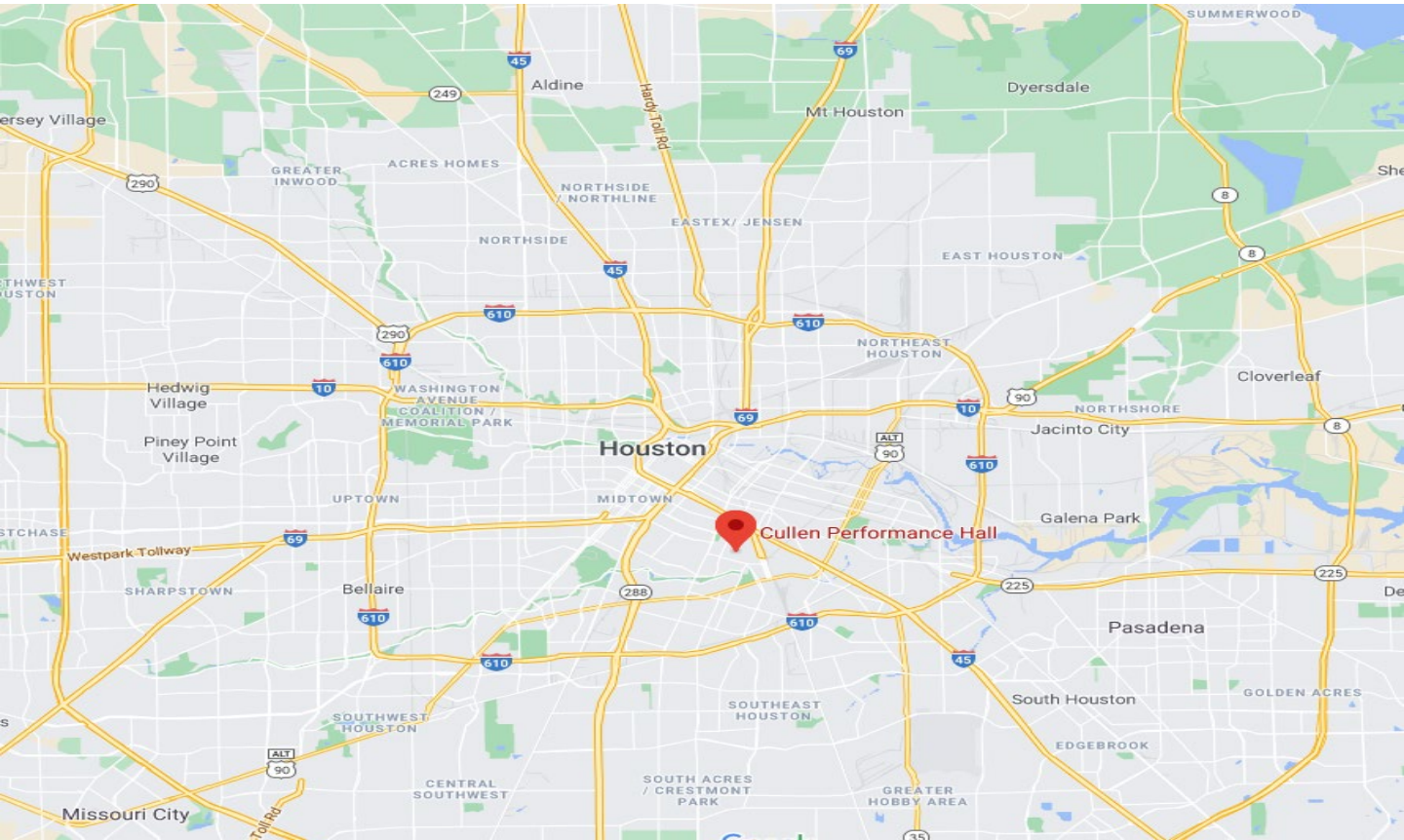

### **Directions from Downtown on I-45 South**

Take I-45 South and Exit spur 5. At the first stop light, (University Drive) take a right turn. At the next stop light (Calhoun), continue going straight. Cullen Performance Hall is at the very end of the road. Parking is available in the parking garage “Welcome Center Visitor Parking”.

### **Directions From Galveston I-45**

Take I-45 North and Exit (Elgin Blvd). At the first stop light (Elgin Blvd) take a left turn, drive under the bridges (Spur 5). At the second stop light turn left onto (Spur 5) feeder road. At the next stop light take a right turn onto (University Drive). At the next light continue going straight to the Cullen Performance Hall is at the very end of the road. Parking is available in the parking garage “Welcome Center Visitor Parking”.



Address: 4300 University Drive, Houston Texas 77204-0001







Address: 4300 University Drive, Houston Texas 77204-0001  
Lot 1D

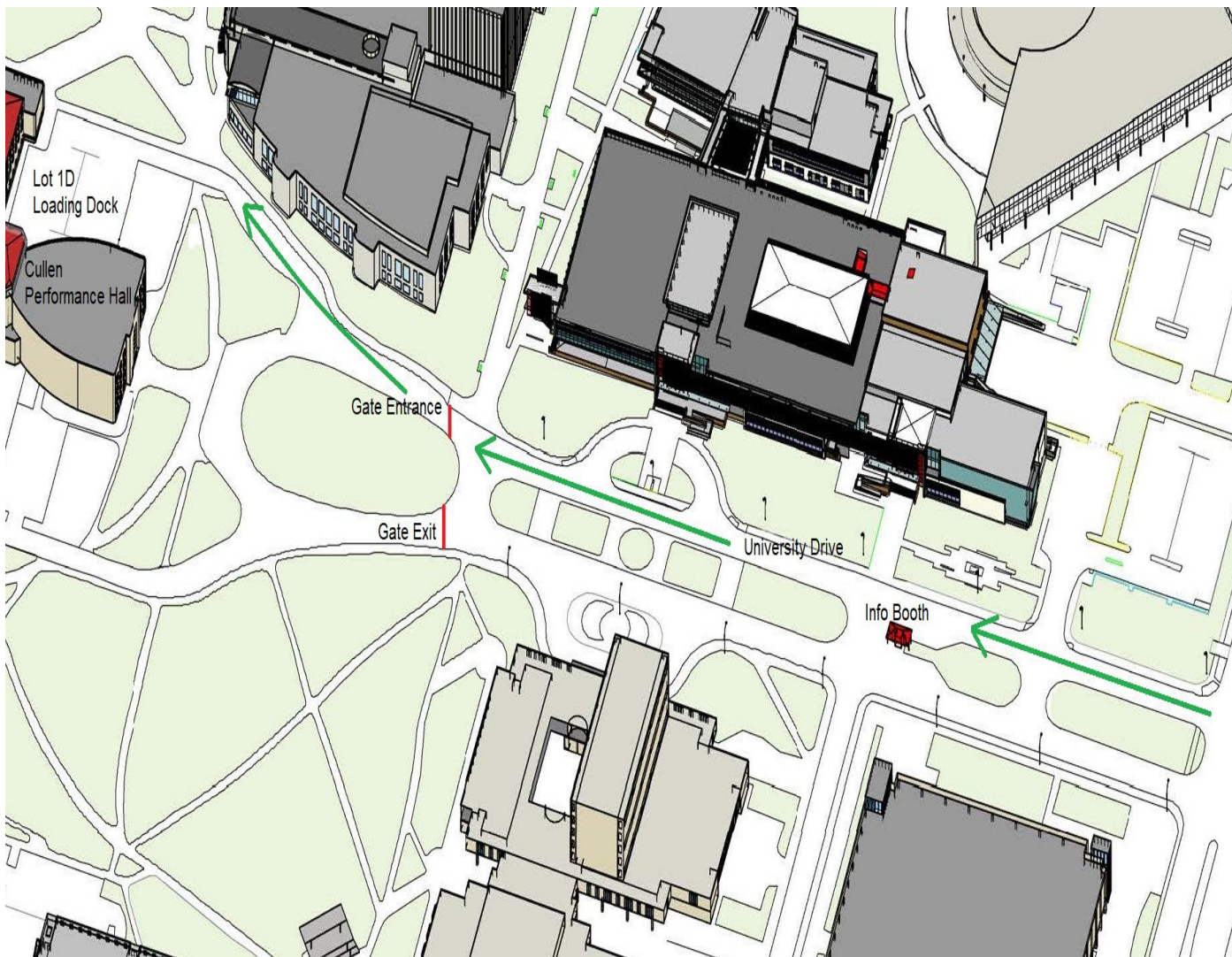



### Parking lot 1D

We can accommodate your needs  
of buses and semi-trucks with trailers.  
(Please let us know in advance)





4434 University Drive, Houston, Texas 77204  
“Welcome Center” “Visitors Parking”

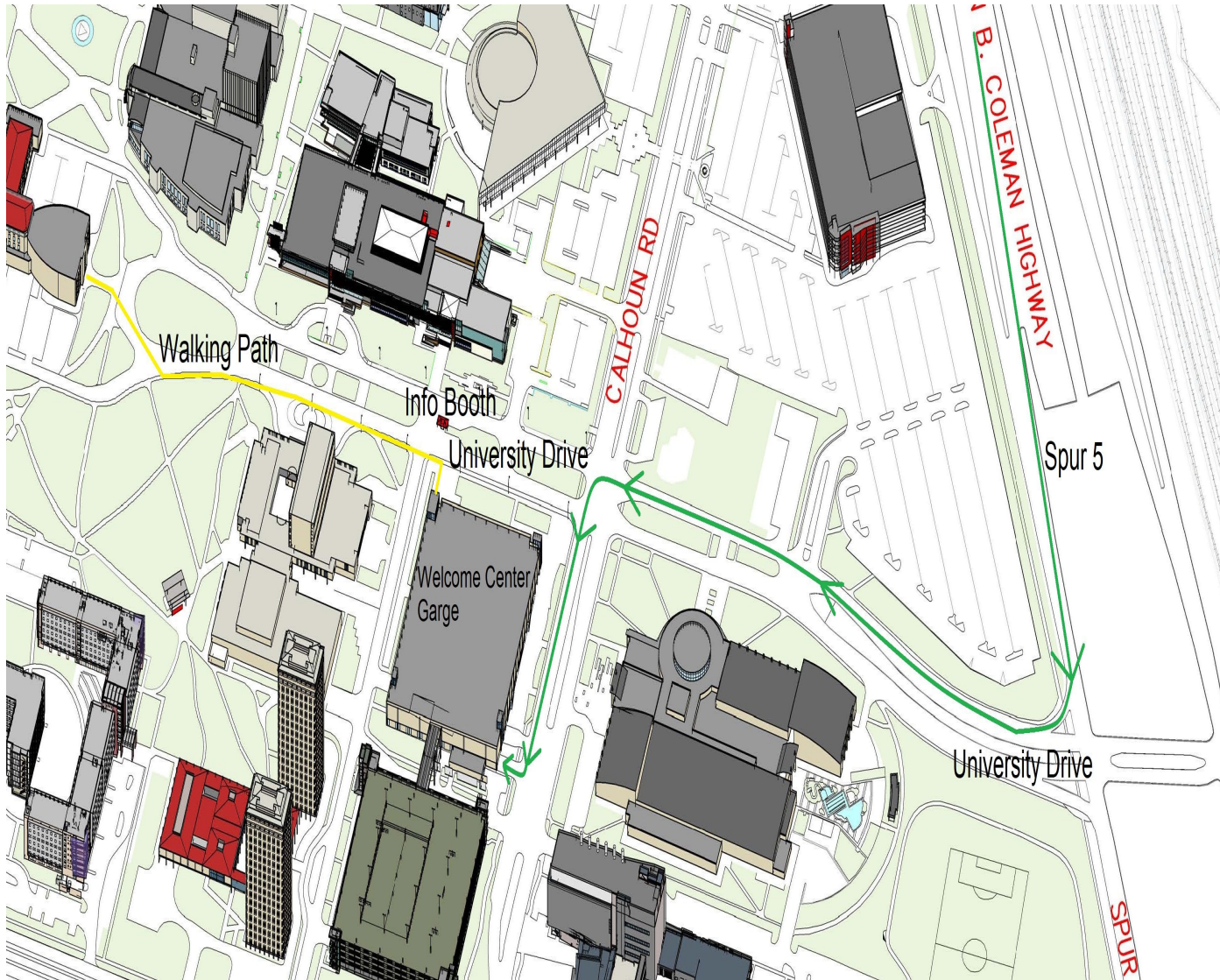



AAA	1	14
BBB	1	15
CCC	1	18
DDD	1	18

Capacity Total:	1612
Pit:	65
Orchestra:	1029
Balcony:	502
Accessible:	16

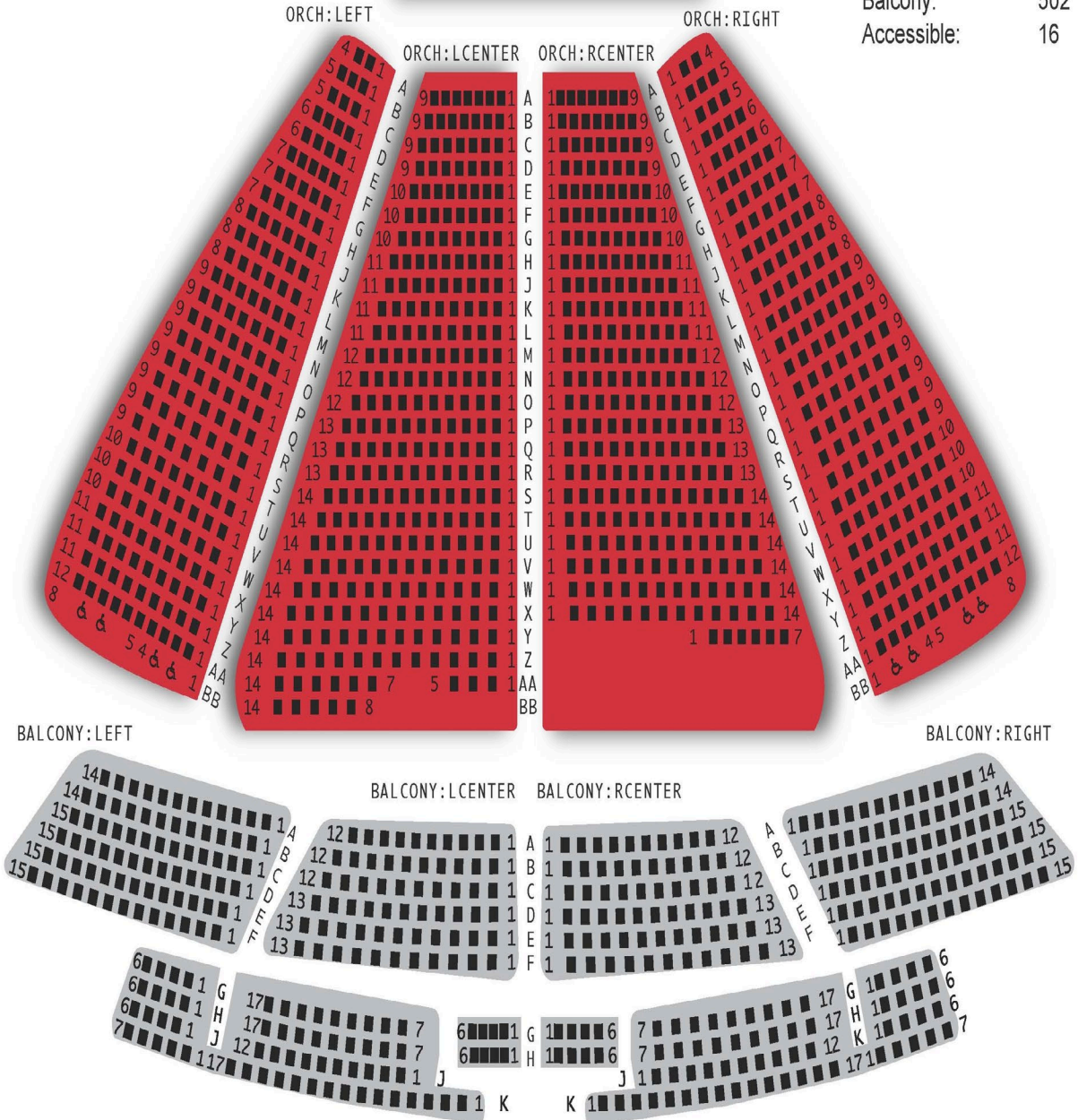







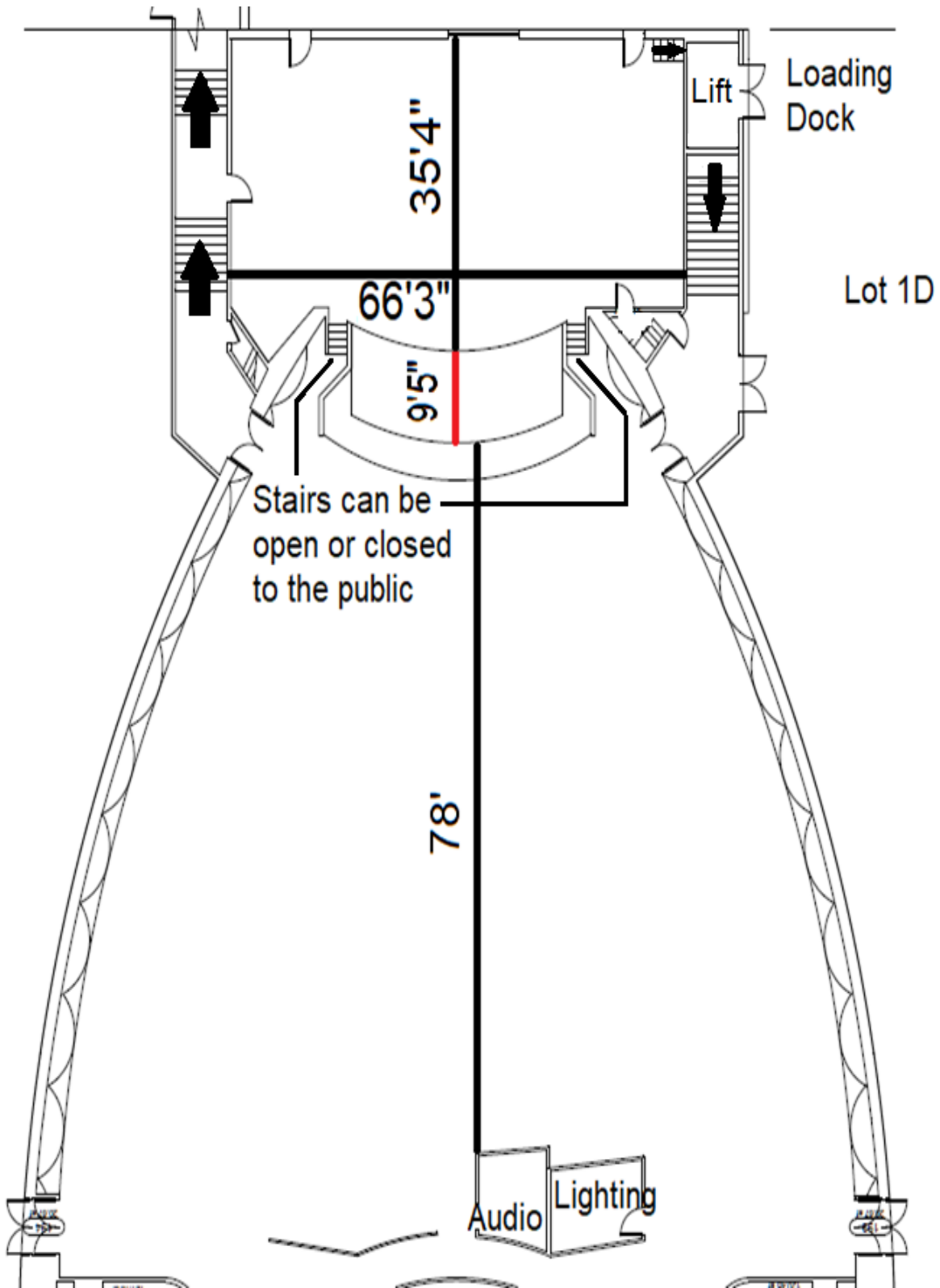

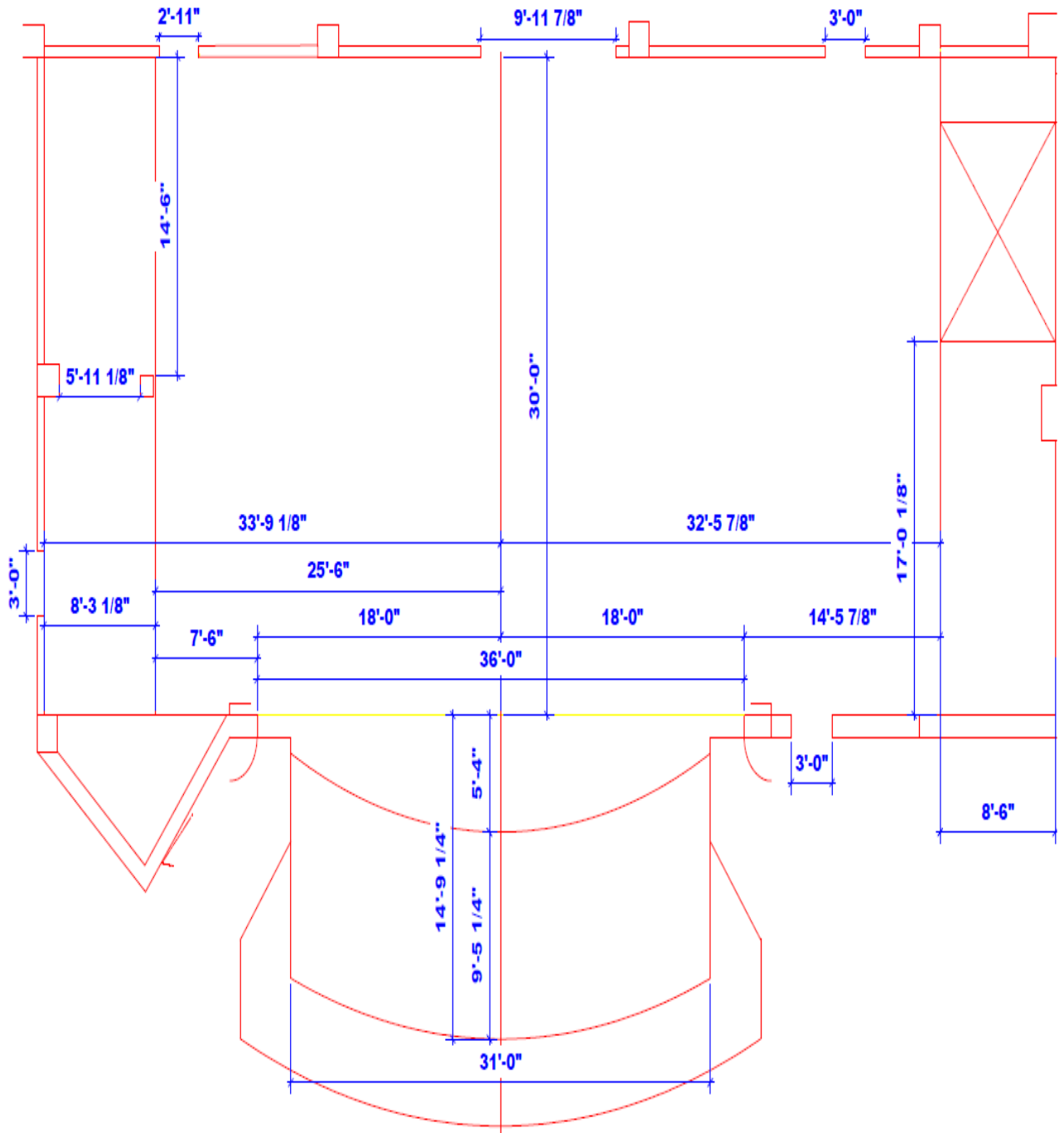



Proscenium Height	27'
Proscenium width	36'
Stage depth without pit	35'4"
Stage depth with pit (less 65 seats)	44'-9 1/4"
Center Line to stage left wall	32'-5 7/8"
Center Line to stage right wall	33'-9 1/8"
Arched stage apron at center line	5'-4" / 14'-9 1/4" w/pit
Grid height	52'-4"
Grid to underside of Roof	6'-9"
Stage Height	3'-7"
Linesets – 30 qty	40' wide
Mix Position from downstage edge	87' 5" / 78' w/pit





Line set #	Plaster line	Function	Type	Loads
	FC 0'6"	Fire Curtain		
1	1'0"	Grand Teaser	Double	500 lbs.
2	2'0"	Grand Drape	Single	850 lbs.
3	2'6"	#1 Black Legs	Double	500 lbs.
1 <sup>st</sup> electric	3'0"	House Electric (Lights)	Electric	
4	4'0"	available	Double	500 lbs.
5	4'6"	Under Maintenance	Single	850 lbs.
6	5'0"	Available	Single	700 lbs.
7	5'6"	Available	Double	500 lbs.
8	6'0"	Available	Double	500 lbs.
2 <sup>nd</sup> electric	6'6"	House Electric (Lights)	Electric	
9	7'0"	#2 Black Legs	Double	500 lbs.
10	7'6"	#1 Border	Single	1,000 lbs.
11	8'0"	Available	Double	500 lbs.
3 <sup>rd</sup> electric	10'0"	House Electric (Projector Screen)	Electric	
13	10'6"	Available	Double	500 lbs.
14	11'0"	#2 Border	Double	500 lbs.
15	11'6"	#3 Black legs	Double	500 lbs.
16	12'6"	Under Maintenance	Double	500 lbs.
17	13'0"	#3 Border	Double	500 lbs.
4 <sup>th</sup> electric	14'0"	House Electric (Lights)	Electric	
18	14'6"	Available	Single	700 lbs.
19	15'0"	Available	Double	500 lbs.
20	15'6"	Mid-stage Black	Double	500 lbs.
21	16'6"	Available	Double	
22	17'0"	Available	Single	550 lbs.
23	17'6"	#4 Border	Single	550 lbs.
24	18'0"	Available	Single	550 lbs.
25	19'0"	#4 Black Legs	Double	
26	19'6"	Under Maintenance	Single	550 lbs.
5 <sup>th</sup> electric	21'0"	House Electric (Lights)	Electric	
27	22'0"	Available	Double	500 lbs.
28	22'6"	Available	Double	500 lbs.
29	23'0"	#5 Border	Double	500 lbs.
6 <sup>th</sup> electric	24'0"	House Electric (Lights)	Electric	
30	24'6"	Under Maintenance	Double	500 lbs.
31	25'0"	Available	Double	500 lbs.
32	25'6"	Full Black	Double	500 lbs.
33	27'0"	Black Scrim	Double	500 lbs.
34	27'6"	White CYC	Double	500 lbs.
35	28'0"	White Scrim	Double	500 lbs.
	30'	Rear Wall		

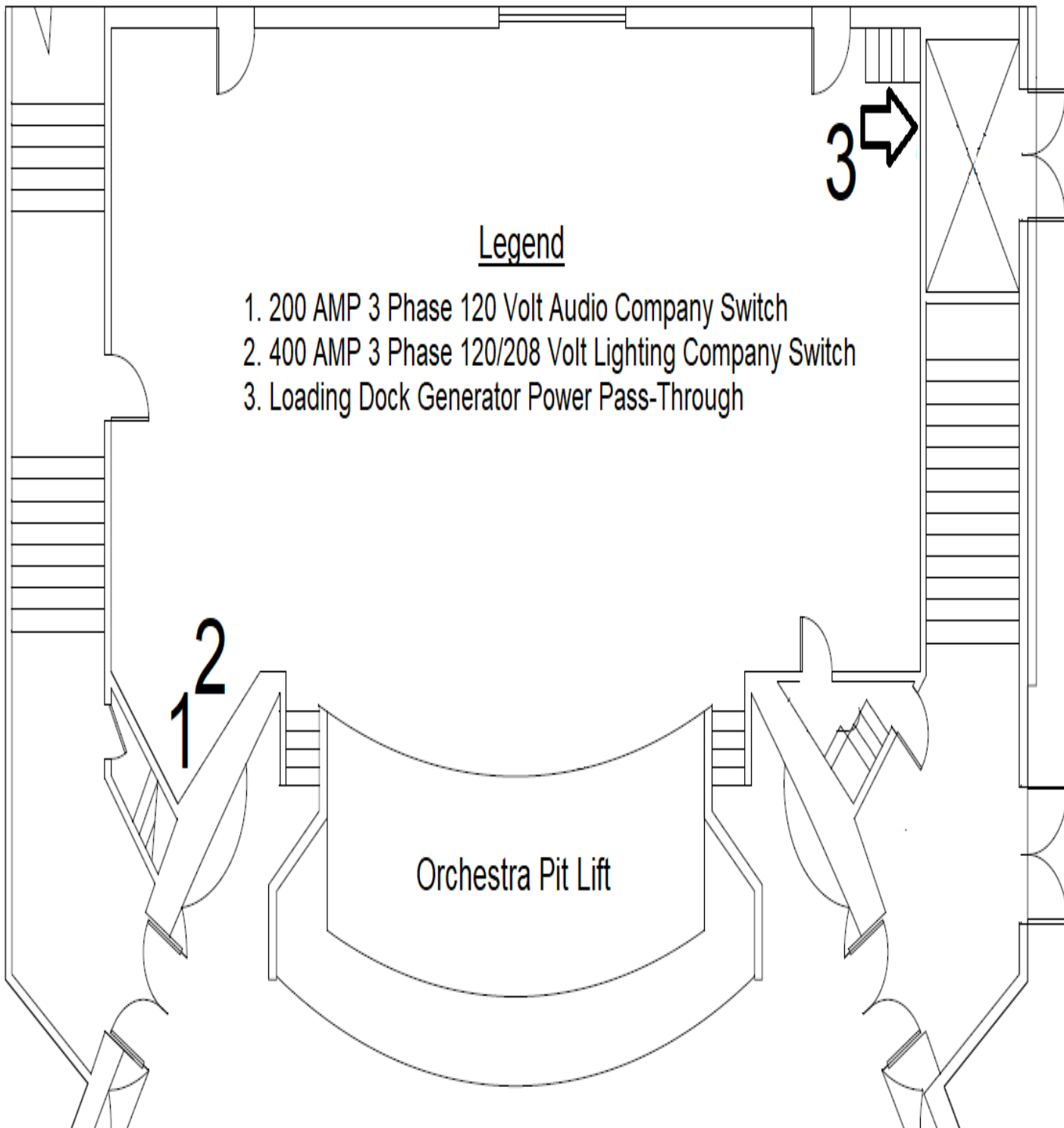

## Dressing room Stage Level

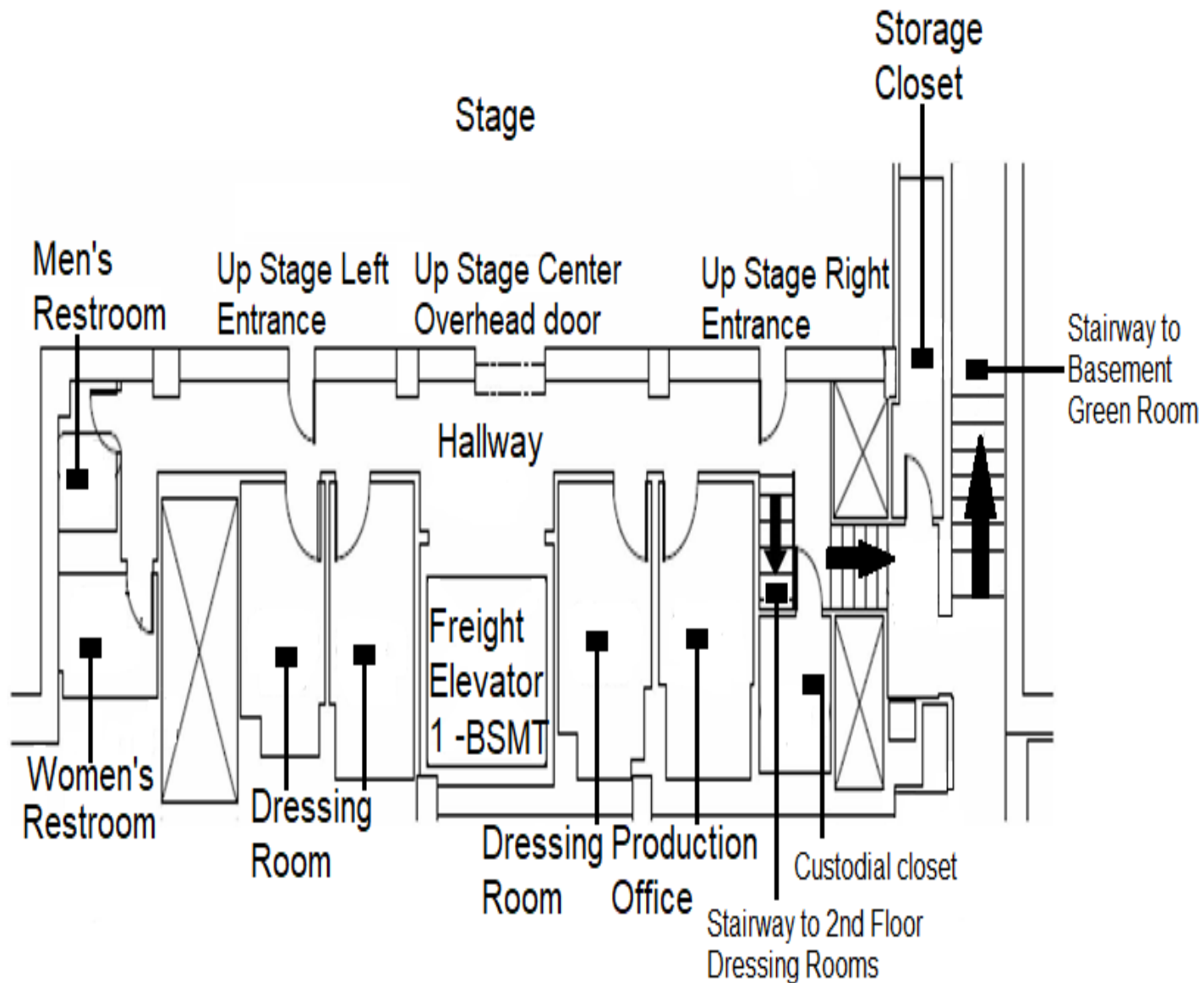



## Dressing Room Second Floor

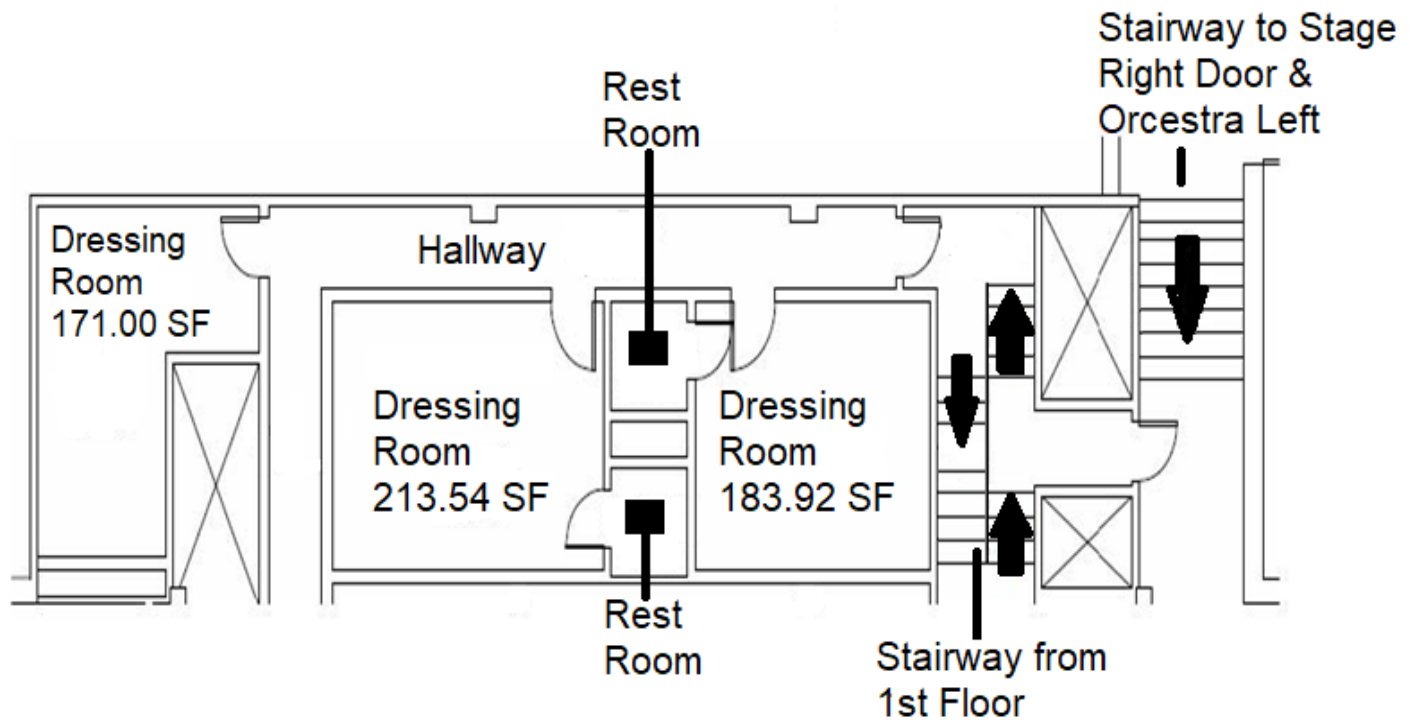

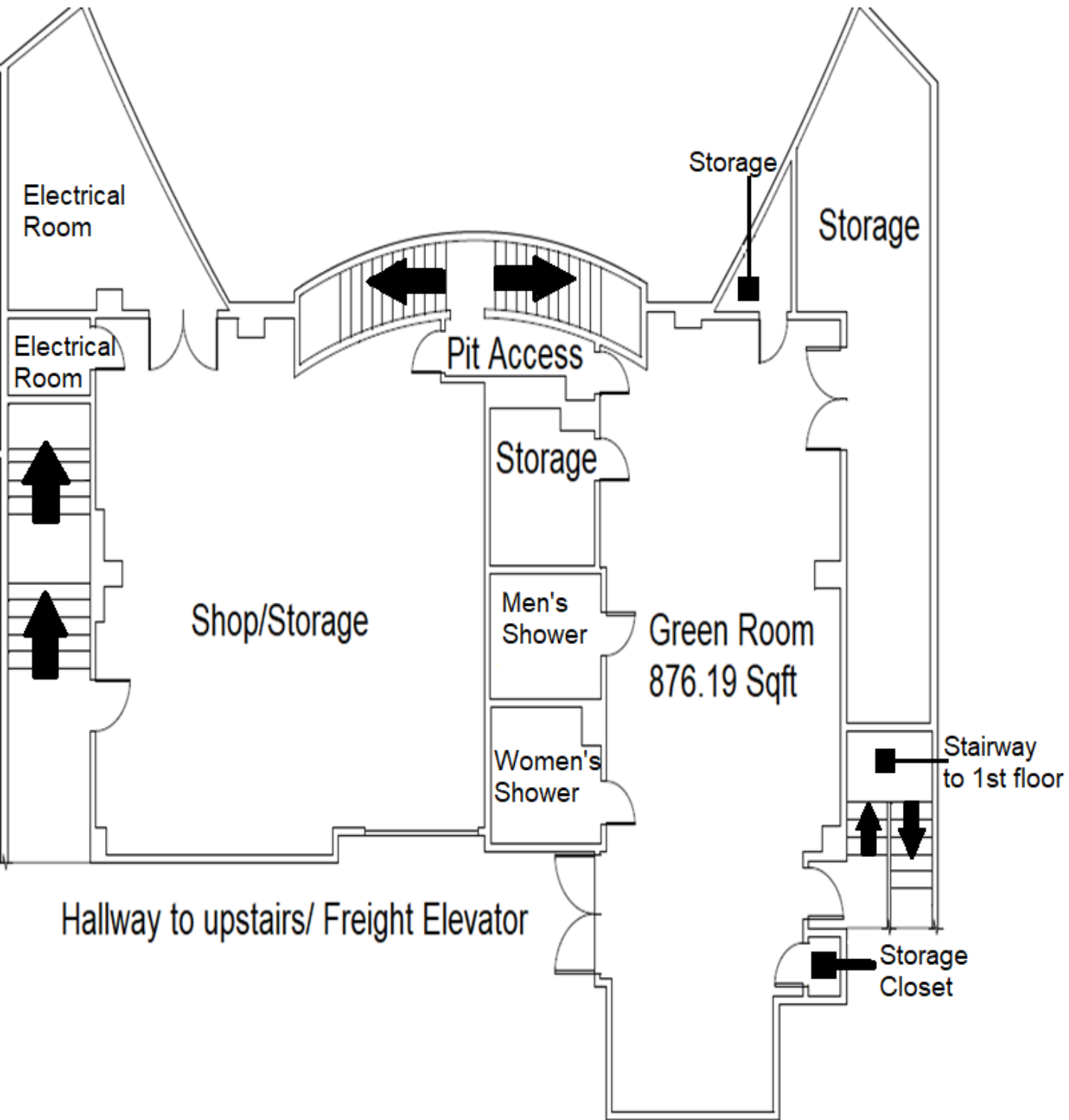



Controller

Quantity	Lighting Console
1	Grand MA 3 Compact XT

Lighting Fixture Inventory

Lighting Equipment	Quantity	Wattage	Beam	Position
Elation KL Par FC	21	284W	22 Degree	FOH/ Stage
ETC S4 10*	23	525-750W	10 Degree	FOH
ETC S4 19*	13	525-750W	19 Degree	FOH
ETC S4 26*	14	525-750W	26 Degree	FOH/ Stage
ETC S4 36*	53	525-750W	36 Degree	FOH/ Stage
ETC S4 50*	9	525-750W	50 Degree	FOH/ Stage
ETC S4 Par*	46	525-750W	18 Degree	FOH/ Stage

Follow Spotlight

Quantity	Fixture
2	Strong Lighting Arc II Long Throw





### Main Sound System

Quantity	Item
1	Allen & Heath Avantis
1	GX4816 & DX168
22	JBL VT4886 as Mains/Fills 18/2
2	JBL PRX 835 W
4	JBL SRX 828S as Subs
4 Yamaha/ 7 JBL	Yamaha CM12V / JBL PRX 412M as Monitors

The front of house mixing console is in the sound mix position, house right of center, beneath the balcony. This is an open-air position.

Quantity	Item
8	Sennheiser EW 500 G4-945
8	Sennheiser MMD 945 Capsule Wireless Handheld
4	SK500 G4 Body Pack
3	DPA 4288 Core Headset Microphone
2	Countryman B6 Lavalier Microphone
2	Countryman E6I Ear Set Head Worn Microphone
10	Sennheiser E604 Dynamic Instrument Microphone
4	Sennheiser E609 Dynamic Instrument Microphone
4	Sennheiser MD 421-II Cardioid/ Dynamic Microphone
4	Sennheiser MEG 14-40 Gooseneck Microphone With Base
4	Sennheiser E 602 II Cardioid Dynamic Instrument Microphone
4	Sennheiser E 614 Super cardioid Condenser Microphone
6	Sennheiser E 835 Dynamic Microphone



Quantity	Item
2	Crown PCC 160 PZM Boundary microphones
4	Shure SM58
5	Audio-Technica Pro-45 Cardioid Condenser Hanging microphone
10	Boom Stand
8	Straight Stand
5	Short Boom Stand
5	Tabletop stands
1	Lex Power Box 100 AMP 15-520 N2/REG
1	ADA podium with image screen and microphone
1	Wooden podium with microphone
2	Clear Acrylic Podium with microphone
2	Whirlwind mic and snake cabling package
2	Stage box 16 channel sends connection

### Amplifiers

Quantity	Item
4	Crown XTI 4002
6	Crown I-Tech 9000

### Video System

Quantity	Fixture
1	Christie Digital D20WU-HS
1	Roland V-160HD Switcher

The projector is permanently installed in the balcony and is capable of being used on the projector screen (located on the second electric down stage) or Mid-stage white Cyc. Note SDI to HDMI is the connection used as the input.

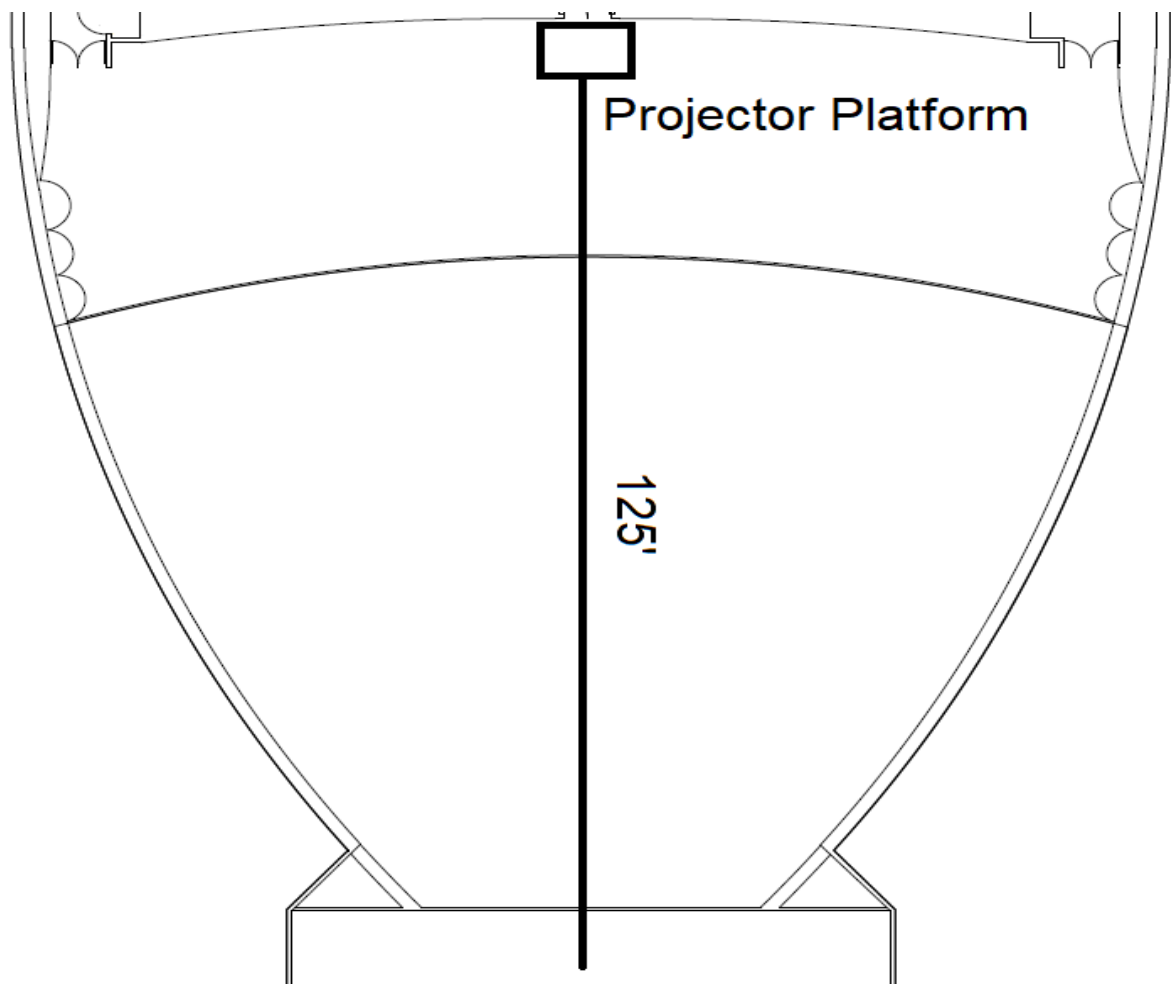

## LOADING ACCESS

Trucks should unload on the Northeast side of the facility through the parking lot at the end of University Blvd (lot 1 D). There is a 7'-8" wide 10' high, double-door loading dock. The doors open to a 11' wide 8' deep, 5000 lbs. capacity lift. The exterior lip of the doors is 16" above the ground and the lift inside is 53" above stage level. The loading door is located up stage left.







VIP Pit Chairs



Red chair



Arm Chair



Orchestra chair

Quantity	Item
115	VIP Pit Chairs
22	Red chair
2	Arm Chair
81	Orchestra Chair



Sofa



Black Chair



Red & Black  
Chair

Quantity	Item
8	Cocktail table
8	End table
2	Coffee table
24	6ft tables
4	8ft tables
2	Black stools
7	Brown wood stools
34	Music stands
41	Red & Black chair
18	Stanchions
10	Sections of 8 Ft tall x 10 Ft long Pipe and Drape

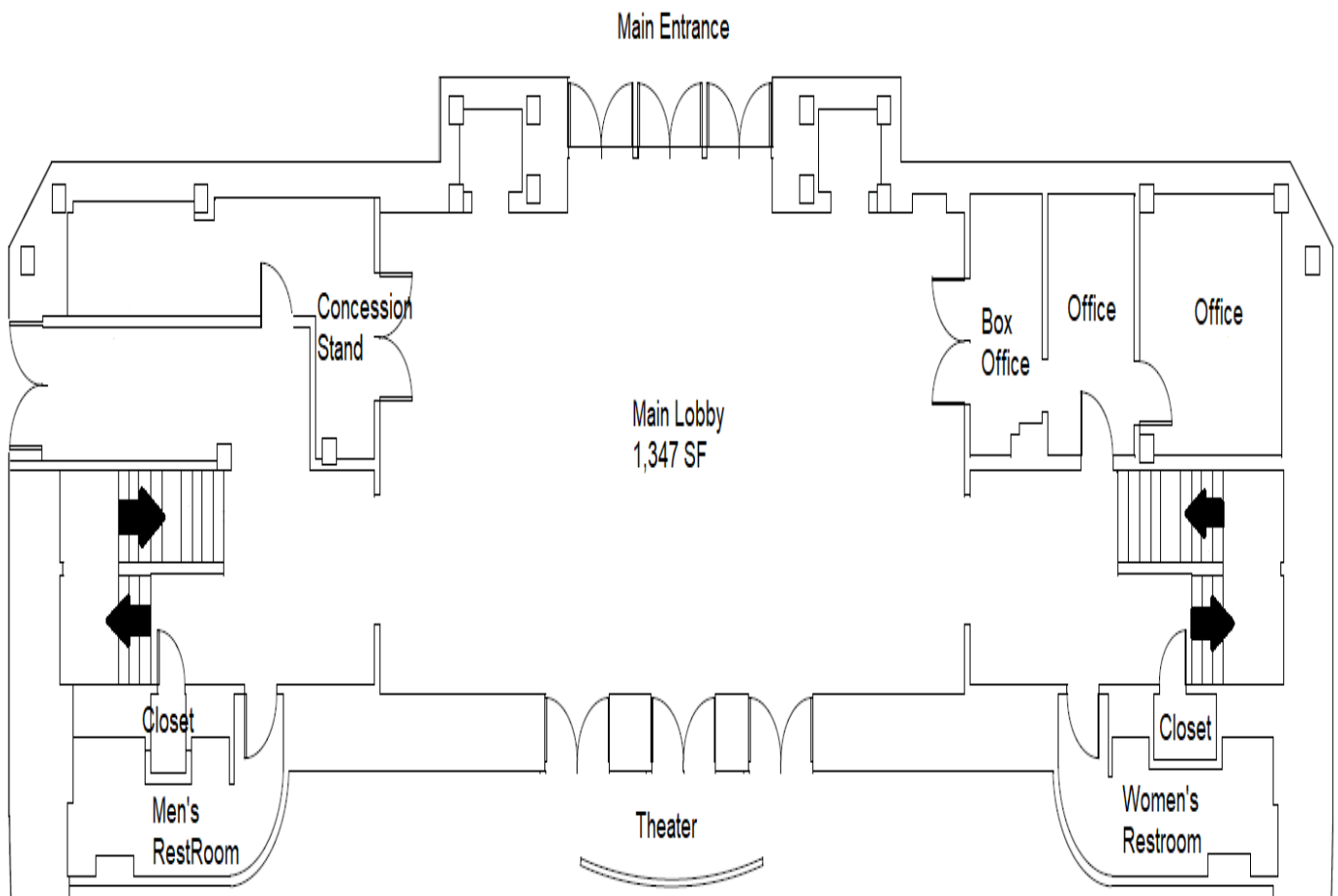
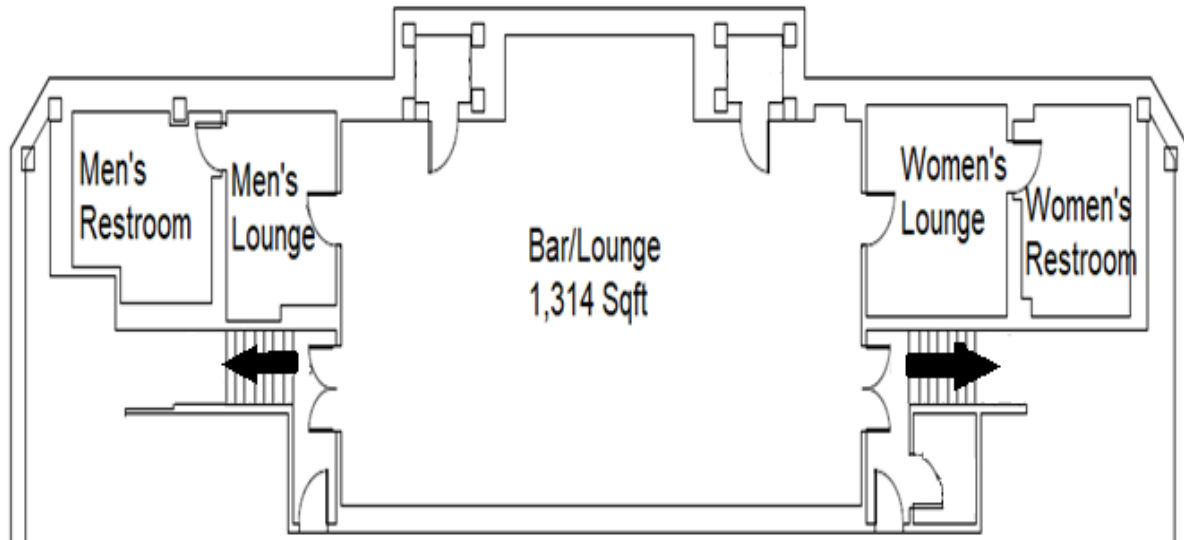

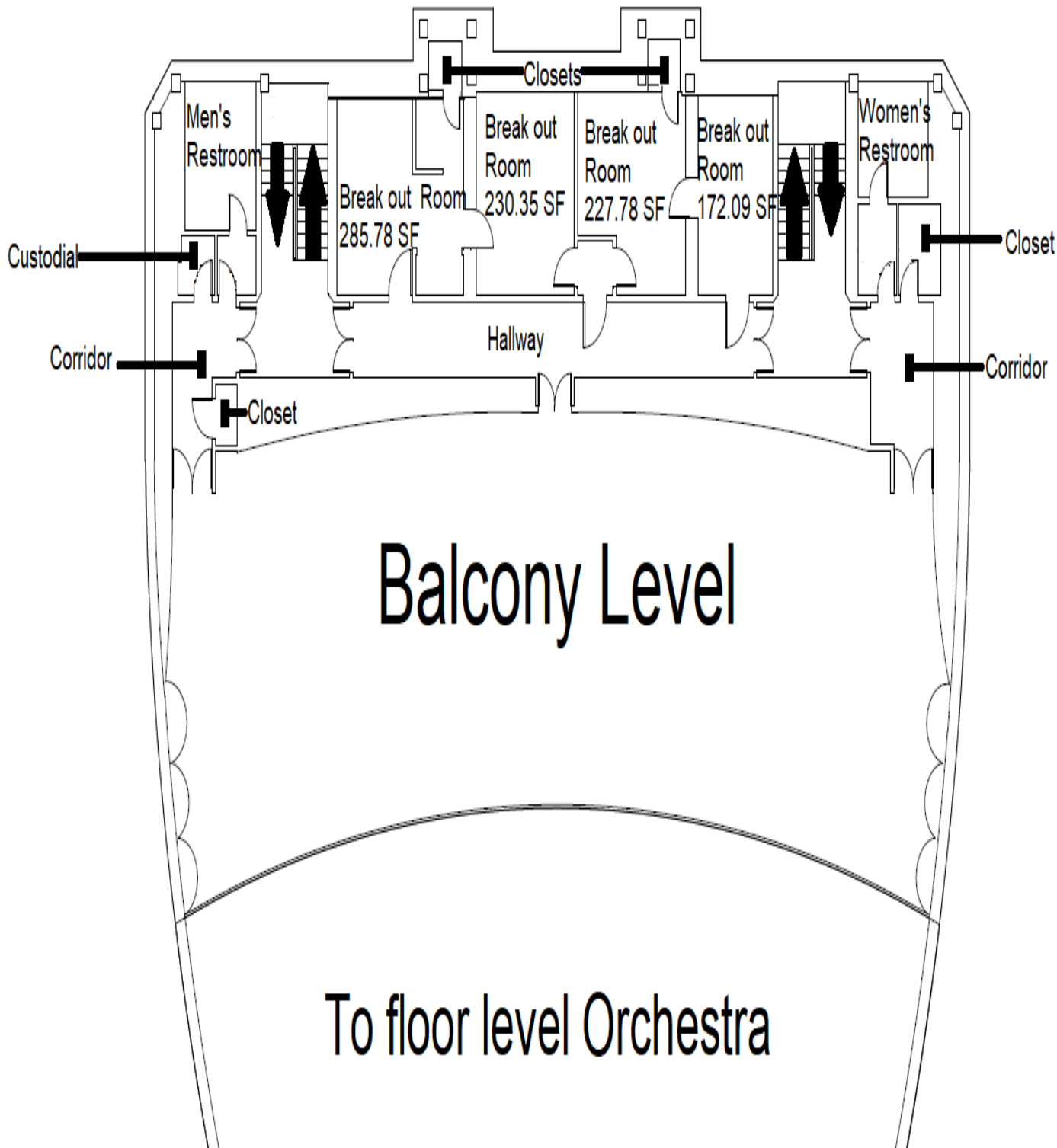







## **COMMUNICATIONS**

Headset stations are located throughout the facility. The auditorium uses a 2 channel Clear-Com system. There is program monitor capability to all dressing rooms.

## **DRESSING ROOMS**

Four dressing rooms are located at stage level, all in a backstage corridor with two toilet facilities on the end of the hall. Each can accommodate 6-8 people. Three dressing rooms with accommodations for 10-15 people, each with toilet facilities, are located backstage on the second floor (accessible by stairs only). All seven rooms are equipped with makeup counters, mirrors, and lights. There is also a green room located in the basement below the stage level dressing space, containing full shower and toilet facilities. It can accommodate up to 80 people.



## **ORCHESTRA PIT**

The orchestra pit is on an electronically-powered screw jack. The movable portion measures 30' wide by 9'-5" deep. Its height can vary from stage level to house level. When at house level the width ranges from 37' downstage and 30' upstage. Access to the orchestra pit is from the auditorium only. There is no basement or stage entrance. With the pit raised to stage level the underside can be accessed from the basement.

## **HOUSE SOFT GOODS**

The Grand Drape and Border are Burgundy Velour. There is a full stage black hung at mid-stage and at the upstage wall. There are 5 sets of black legs and 3 borders for masking.

## **TELEPHONE SERVICES AND HIGH-SPEED INTERNET**

Dressing Room D1 (production office) has one land line. The theater has wireless internet. Additional wireless internet connection for back of house/dressing rooms would need to be requested.



**Cullen Performance Hall**  
**UNIVERSITY OF HOUSTON**



**CULLEN PERFORMANCE HALL**  
**At University of Houston**  
**4300 University Dr,**  
**Houston, TX 77204**